[illegible]

All original equipment, manufacturer's names, numbers, symbols and description used in this catalogue are for reference purposes only.

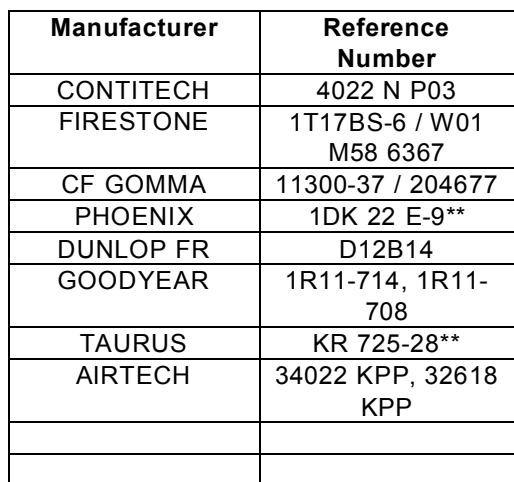

All original equipment, manufacturer's names, numbers, symbols and description used in this catalogue are for reference purposes only.

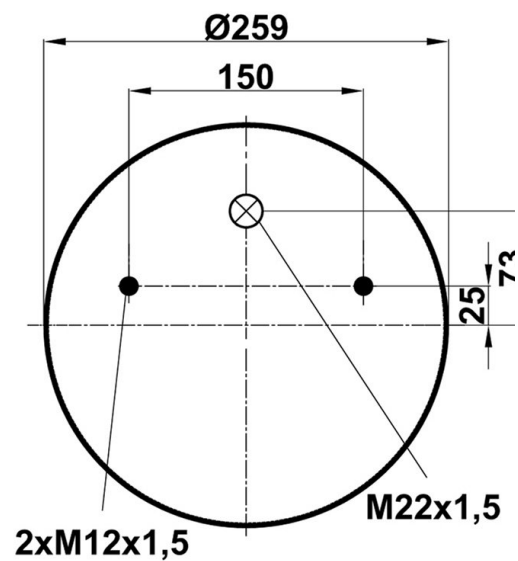

*Stock No: 453*

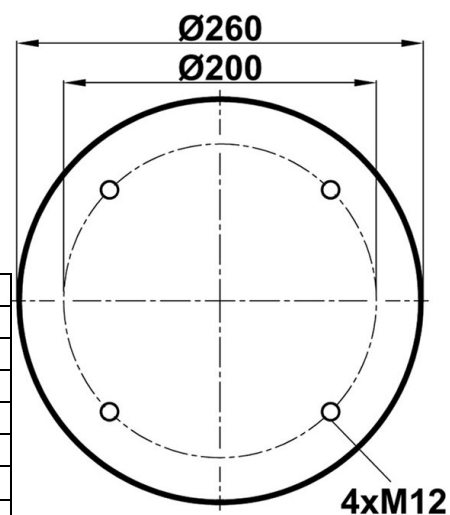
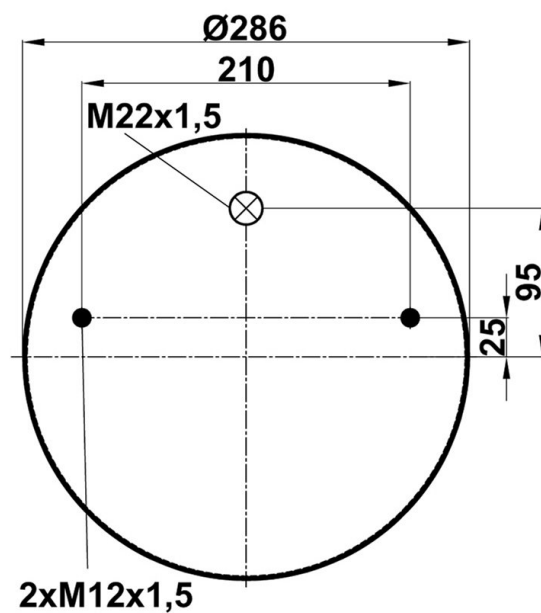
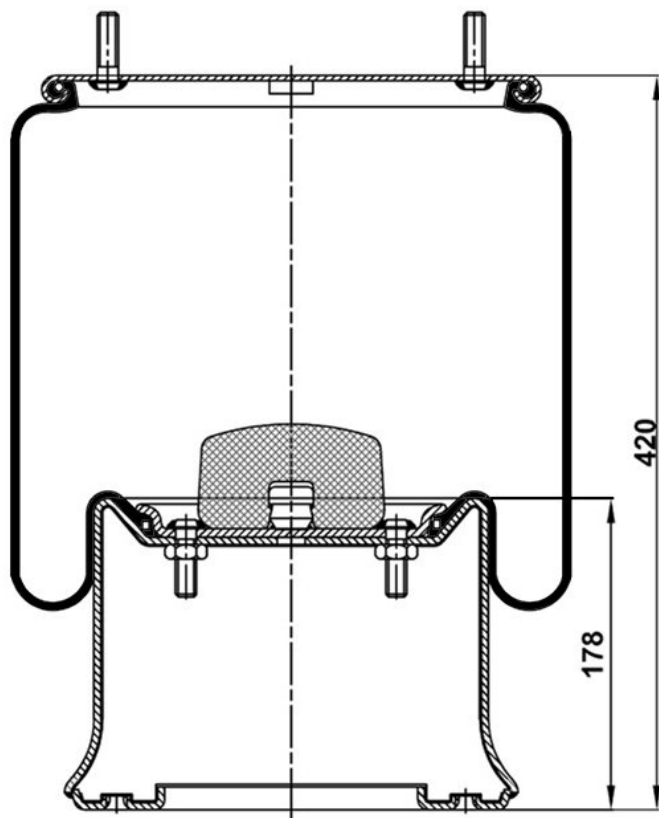

Manufacturer	Reference Number
CONTITECH	4023 N P03
FIRESTONE	1T19F-11 / W01 M58 6348
CF GOMMA	1T19E-2 / 204676
PHOENIX	1D 28 B=10
DUNLOP FR	D13B26
GOODYEAR	1R14-729
TAURUS	KR 622-18
AIRTECH	34023 K

[illegible]

All original equipment, manufacturer's names, numbers, symbols and description used in this catalogue are for reference purposes only.



*Stock No: 454*

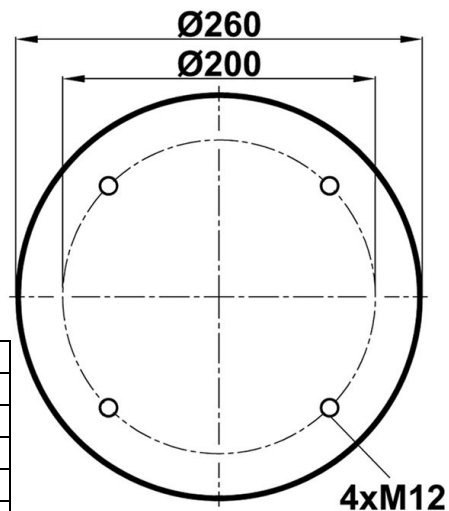
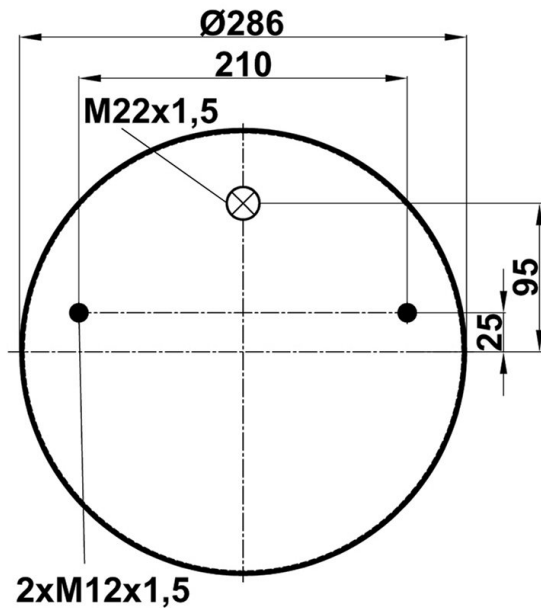
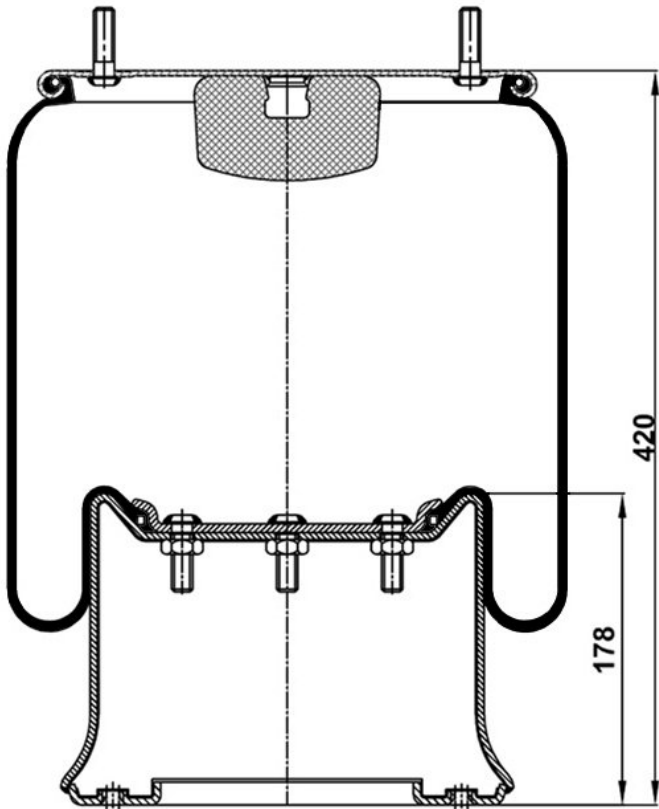

Manufacturer	Reference Number
CONTITECH	4028 N P02
FIRESTONE	1T19L-12 / W01 M58 8106
PHOENIX	1D 28 F-1
GOODYEAR	1R14-783
AIRTECH	34028 K

[illegible]

All original equipment, manufacturer's names, numbers, symbols and description used in this catalogue are for reference purposes only.



Stock No: 455

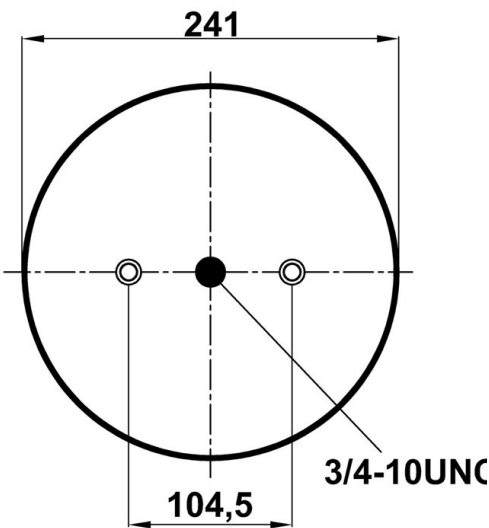
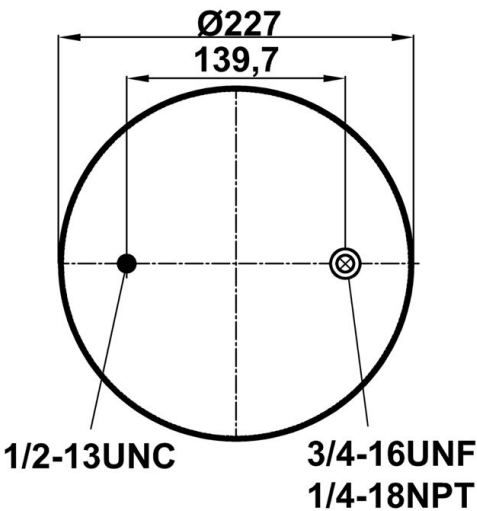
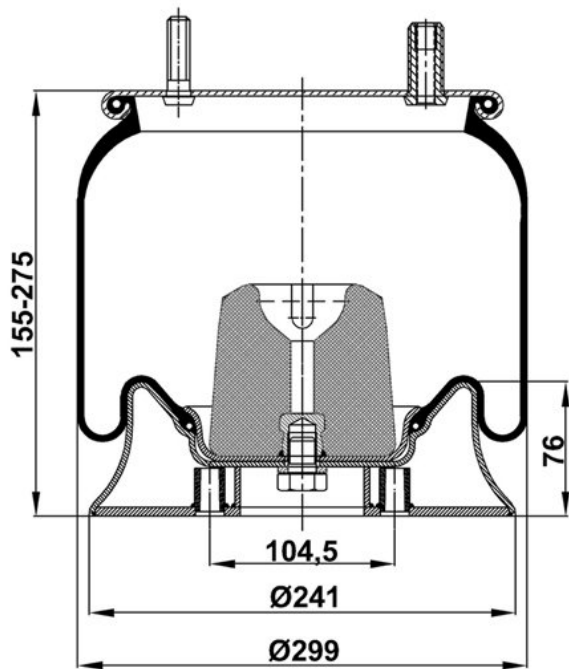

Manufacturer	Reference Number
CONTITECH	4150 N P04
FIRESTONE	1T15M-0 / W01 358 9039**
GOODYEAR	1R12-095**
TAURUS	KR 500-9039**
TAURUS	KR 500-22SU**
AIRTECH	34150 K

OE Reference Number
BELLE TRAILERS BT0321
HENDRICKSON NA1808
HENDRICKSON B2064
NEWAY 90557011
NEWAY 90557023
NEWAY 90557085
R.O.R./MERITOR 21208939
R.O.R./MERITOR 21211613
R.O.R./MERITOR 21216135

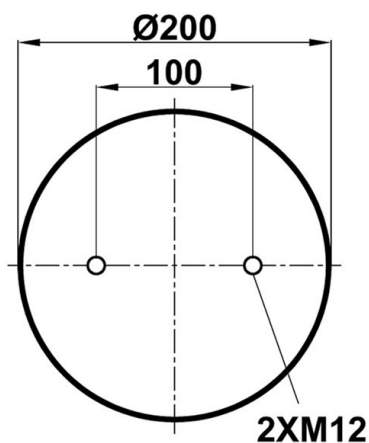
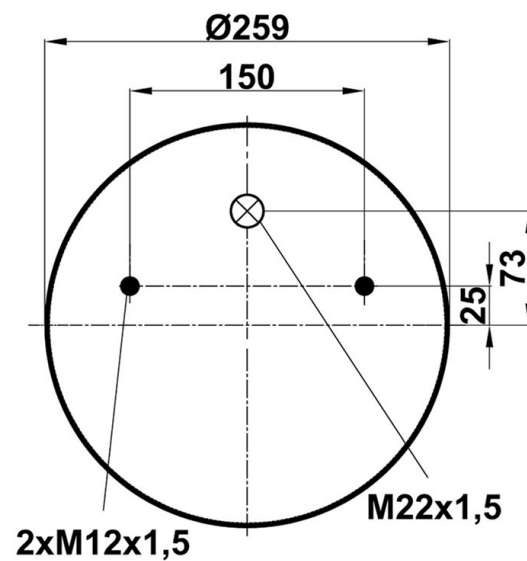

<b>Manufacturer</b>	<b>Reference Number</b>
CONTITECH	4157 N P04
FIRESTONE	1T15MPW-7 / W01 M58 6297**
PHOENIX	1DK 21 A-8
DUNLOP FR	D12B18
GOODYEAR	1R11-111
TAURUS	KR 915-54
AIRTECH	34157 KPP

[illegible]

All original equipment, manufacturer's names, numbers, symbols and description used in this catalogue are for reference purposes only.

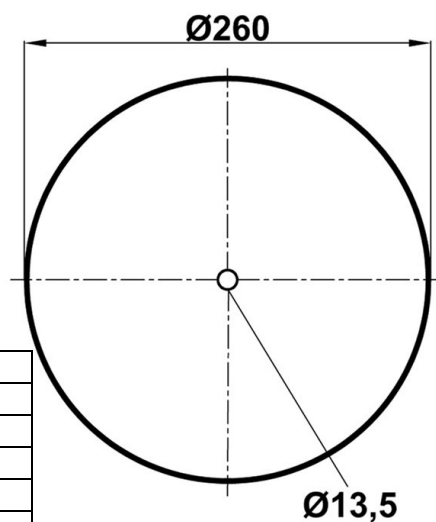
[illegible]

All original equipment, manufacturer's names, numbers, symbols and description used in this catalogue are for reference purposes only.





*Stock No: 458*

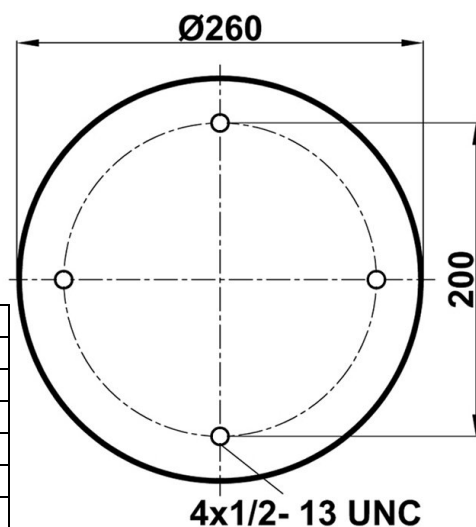
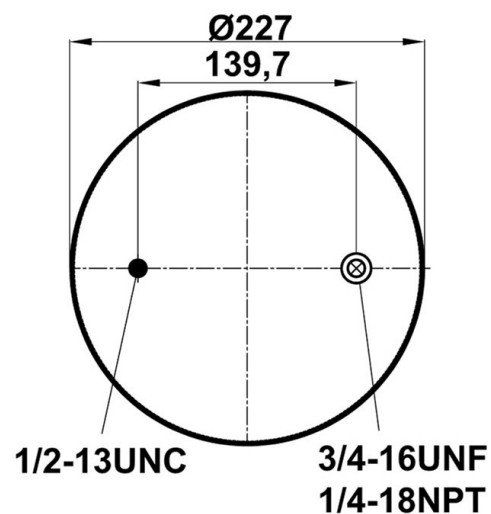
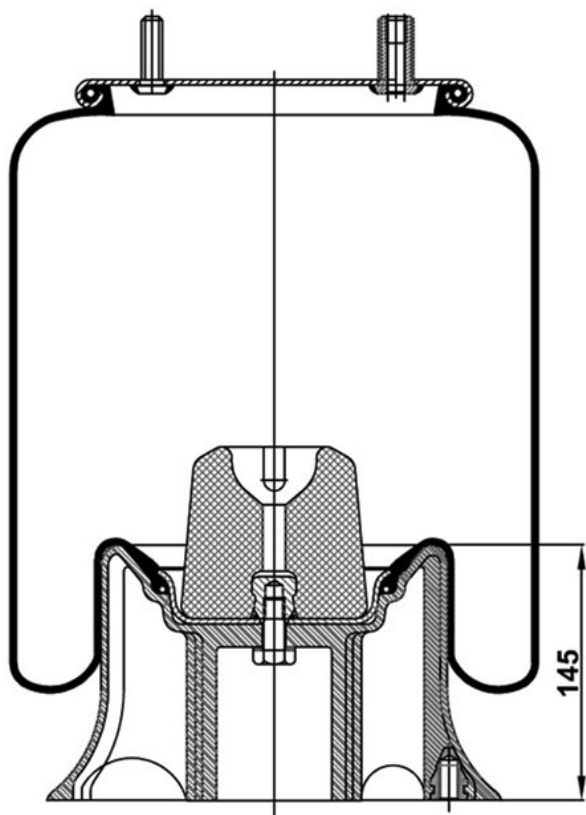

Manufacturer	Reference Number
CONTITECH	4159 N P13
FIRESTONE	1T15M-9 / W01 358 9192
GOODYEAR	1R12-167
AIRTECH	34159-08 KPP

OE Reference Number
DAYTON 352-919
HENDRICKSON NA181
HENDRICKSON S619
LOADGUARD SC2102
NAVISTAR 1681738C
NAVISTAR 1681740C1
NEWAY 9055708
NEWAY 9055710
NEWAY 9055713
NEWAY 90557136
RIDEWELL 1003589192
TRIANGLE 8326
WATSON & CHALIN AS-0038
WATSON & CHALIN AS-0046

All original equipment, manufacturer's names, numbers, symbols and description used in this catalogue are for reference purposes only.





*Stock No: 459*

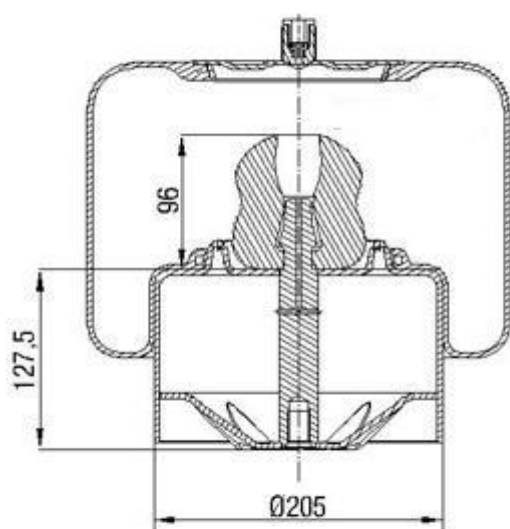

TOP VIEW

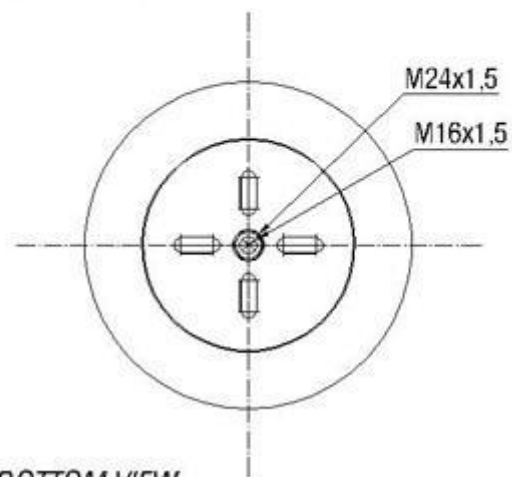

BOTTOM VIEW

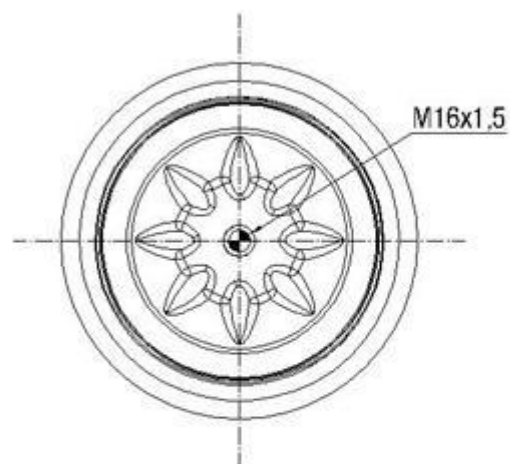

MANUFACTURER	CROSS REFERENCE	OE REFERENCE
MERCEDES	N/A	A 6293200025
DAIMLER	N/A	A 629 327 00 01
CHRYSLER		
EVOBUS	N/A	A 629 327 0001

All original equipment, manufacturer's names, numbers, symbols and description used in this catalogue are for reference purposes only.

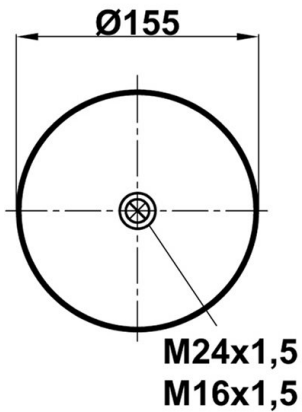
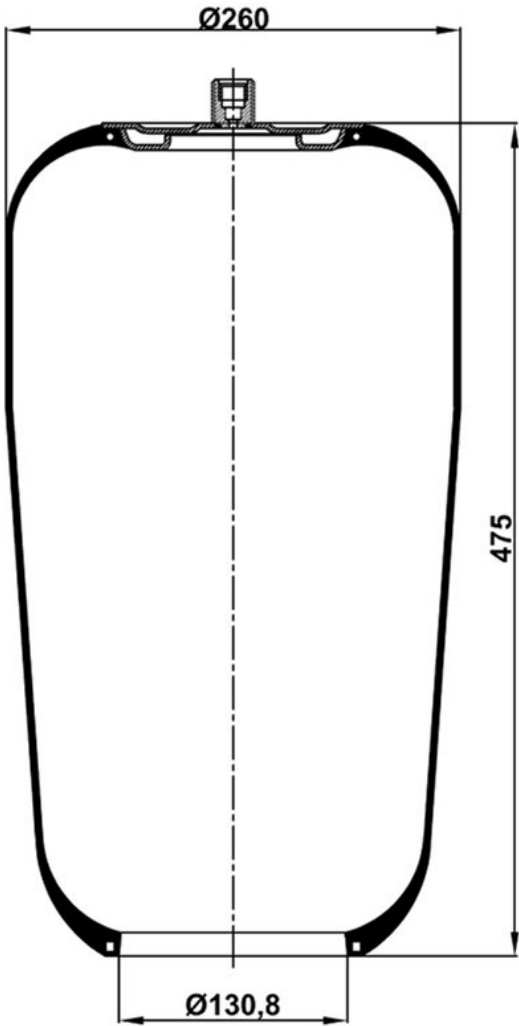

*Stock No: 460*

[illegible][illegible]

All original equipment, manufacturer's names, numbers, symbols and description used in this catalogue are for reference purposes only.

